



BURKE COMMUNITY

Explore our extensive range of
beautiful home designs.

 7620 NE Bothell Way
Kenmore, WA, 98028

GreencityHomes.us



A new community with so much to offer.

Welcome to Burke 38 in Kenmore—Greencity's newest gem, thoughtfully designed around your lifestyle. Explore thirty-eight modern homes with varying floor plans that elevate everyday living with attached garages, bonus space to make your own, bright spaces with expansive windows, inviting outdoor spaces, sun-drenched rooftop decks, luxurious four-piece primary suites, and so much more.



About the Burke Community.

Main living areas are thoughtfully curated to support everything from effortless weeknight meals to stylish soirées. Enjoy an open-concept layout that seamlessly blends culinary function with sophisticated ambiance. Gourmet kitchens feature premium stainless steel appliances, dazzling quartz countertops, and custom cabinetry handcrafted by local artisans—all complemented by generous prep space that invites creativity and connection.

Crown your home with a stunning rooftop deck—a true year-round retreat. Whether you're hosting starlit dinners, enjoying a glass of wine at sunset, or simply unwinding in peaceful solitude, this elevated sanctuary delivers panoramic views and refined comfort. It's more than a rooftop—it's an extension of your lifestyle.

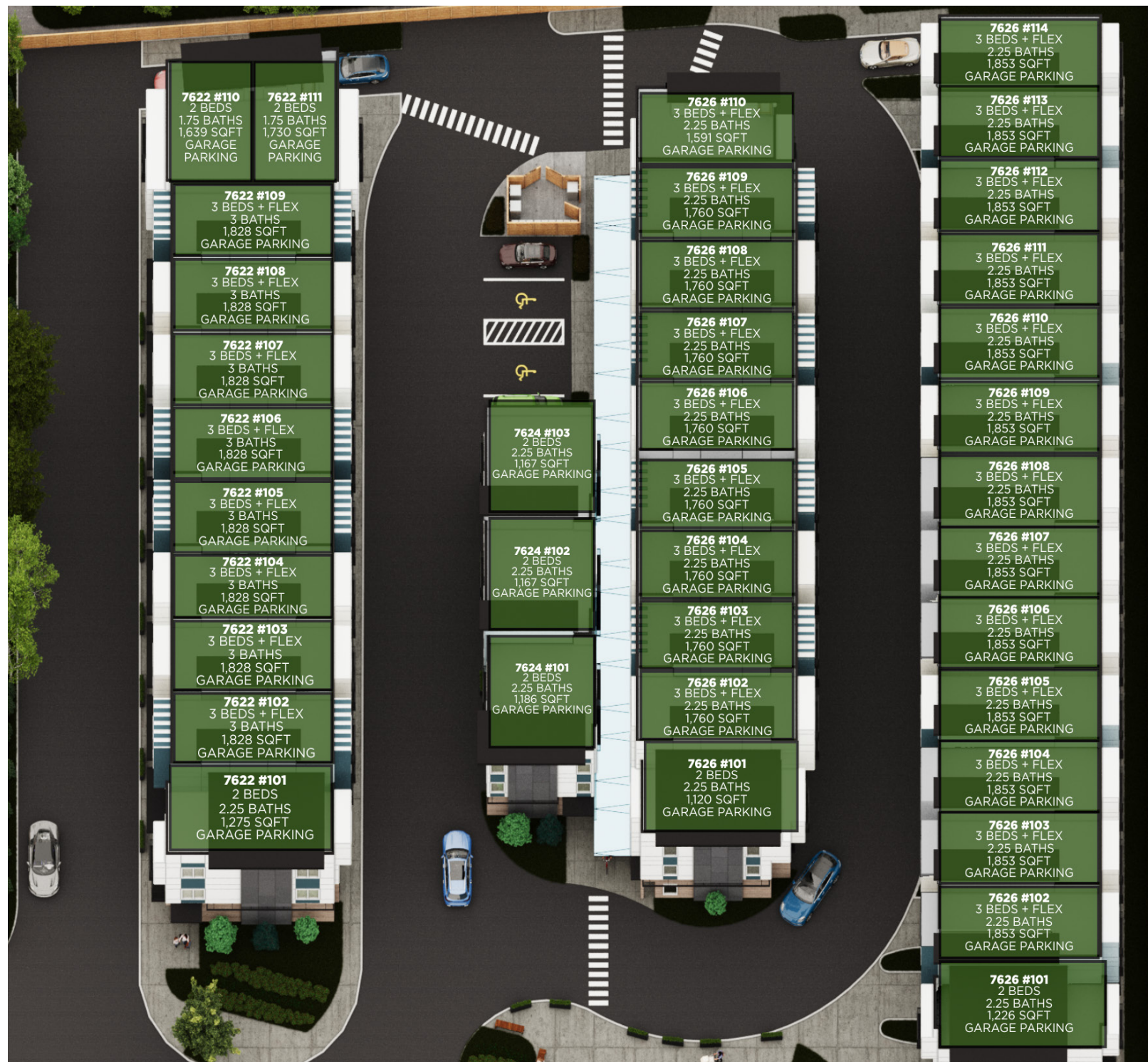

CHOOSE YOUR MODEL HOME

KENMORE LUXURY TOWNHOMES

1,120 - 1,853 Sq. Ft.
2 - 3 BEDROOMS
1.75 - 2.25 BATHROOMS
GARAGE PARKING

PREMIUM FIXTURES & FINISHES
GARAGE PARKING INCLUDED
FLEX SPACE AVAILABLE
LIGHT & BRIGHT SPACES



Choose Your Floor Plan

With four available homes, there's something here for everyone.



2 BEDROOM HOMES

2 BEDS | 1.75 - 2.25 BATHS | 1,120 - 1,730_{SF} | GARAGE PARKING

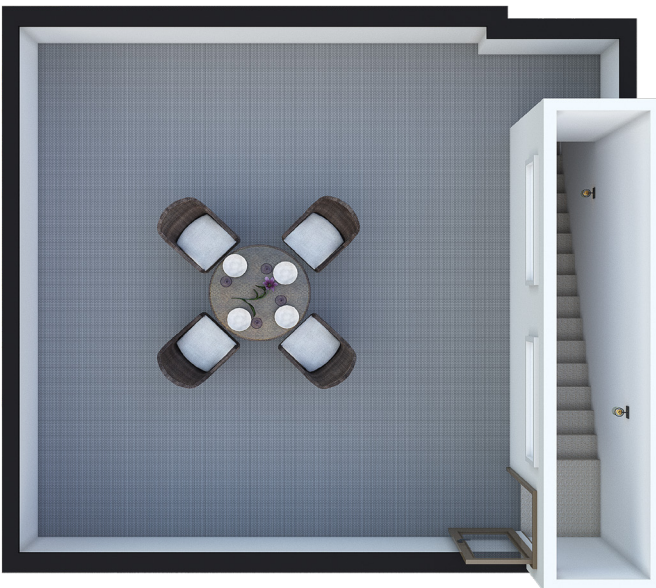

3 BEDROOM HOMES

3 BEDS | 2.25 - 3 BATHS | 1,591 - 1,828_{SF} | GARAGE PARKING



The Surrounding Area

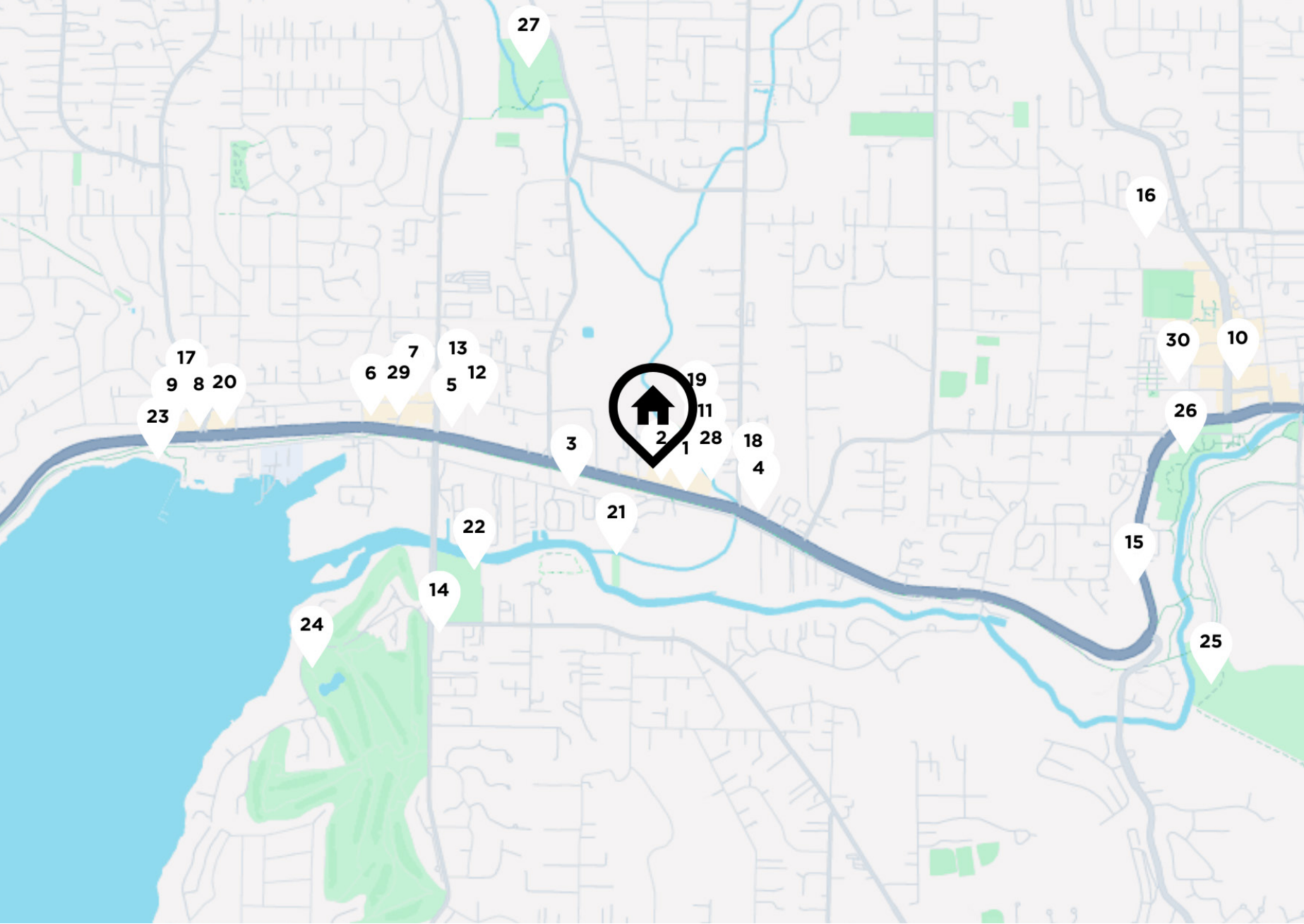

Greencity Favorites



- EATERIES**
- 1. Kataliya Thai House
 - 2. Jay's Cafe
 - 3. De La Soil
 - 4. Taqueria La Raza
 - 5. Toshi's Teriyaki
 - 6. Toma Sushi Restaurant and Bar
 - 7. Stoup Brewing
 - 8. Buddha Bruddah
 - 9. Acapulco Fresh Mexican Grill
 - 10. The Cottage



- DAILY CONVENIENCES**
- 11. Grocery Outlet
 - 12. Safeway
 - 13. Town Market
 - 14. Manhattan Express Grocery
 - 15. Yakima Fruit Market & Nursery
 - 16. QFC
 - 17. Uplake Grocery & Deli
 - 18. Chevron
 - 19. Shell
 - 20. 76



PARKS & ENTERTAINMENT

- 21. Kenmore Paddle Park
- 22. Rhododendron Park
- 23. Log Boom Park
- 24. Inglewood Golf Club
- 25. Blyth Park
- 26. The Park at Bothell Landing
- 27. Wallace Swamp Creek Park
- 28. Kenmore Lanes
- 29. Kenmore Library
- 30. Bothell Library



EDUCATION

- Kenmore Elementary School
- Kenmore Middle School
- Inglemoor High School
- Cascadia College
- Bastyr University
- Seattle University
- University of Washington

**Have a Question?
Speak with our team.**

VWP Real Estate | Burke 38 Community

Community Location:
7620 NE Bothell Way,
Kenmore WA, 98028



Lead Broker & Primary Contact
Diana Rayo
VWP Real Estate
diana.rayo@windermere.com
206-240-9128



Preferred Lender
Bret Eickhoff, MBA
Cornerstone Home Lending
bret@breteickhoff.com
425-241-8082



Scan to learn more

Greencity Homes reserves the right to change or amend plans and specification without prior notice. Specifications may vary per plan. All dimensions are approximate. Information is deemed to be correct but not guaranteed.



AVAILABLE PROJECTS



COMING SOON

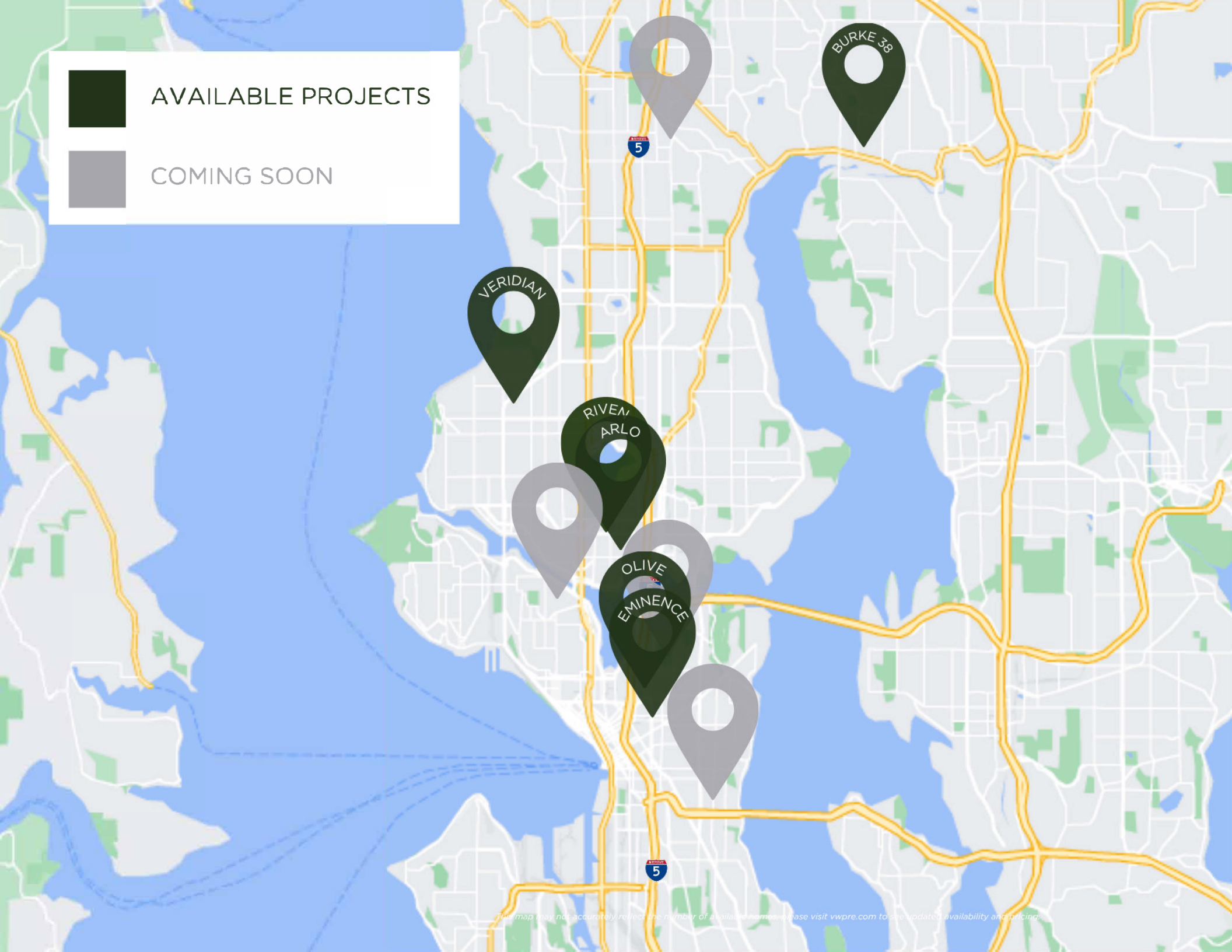

This map may not accurately reflect the number of available homes. Please visit vwpre.com to see updated availability and pricing.